

Use this form to mark where you want the door(s) and window(s) in your standard apex workshop. Use the blue grid to mark out the footprint of the workshop you want. Wall panels come in 2 sizes, a single and a double. Windows are in the double panels and mark these with a W. Standard doors come in double panels so mark these with D1, wide doors come in a double panel and single combined panel and are marked D2, and double doors come in a combined double panel marked D3. The purple lines show the roof overhang, if you have ordered a model with an external covered space.

See the attached worked examples.

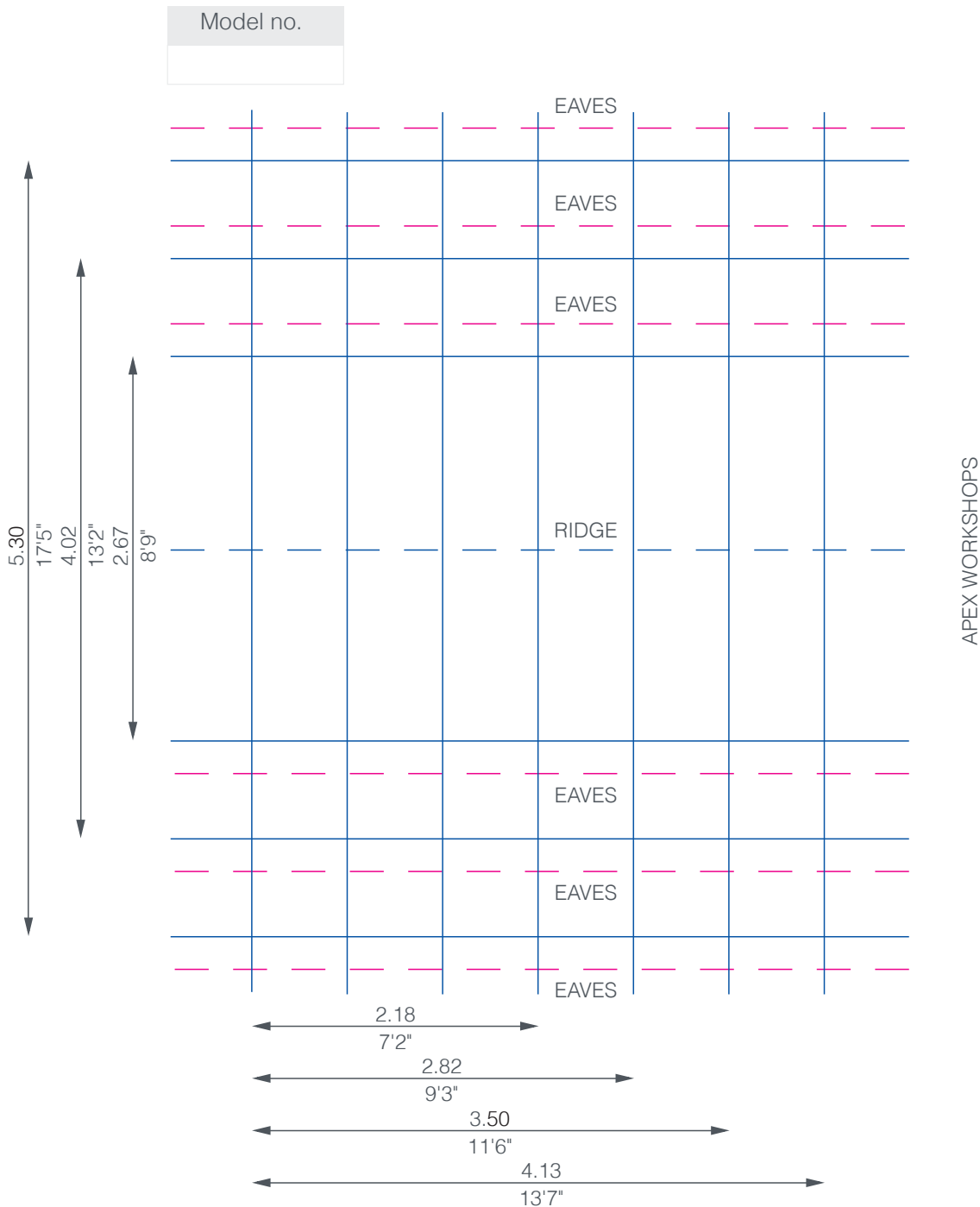

Use this form to mark where you want the door(s) and window(s) in your standard lean-to workshop. Use the blue grid to mark out the footprint of the workshop you want. Wall panels come in 2 sizes, a single and a double. Windows are in the double panels and mark these with a W. Standard doors come in double panels so mark these with D1, wide doors come in a double panel and single combined panel and are marked D2, and double doors come in a combined double panel marked D3. The purple lines show the roof overhang, if you have ordered a model with an external covered space.

See the attached worked examples.

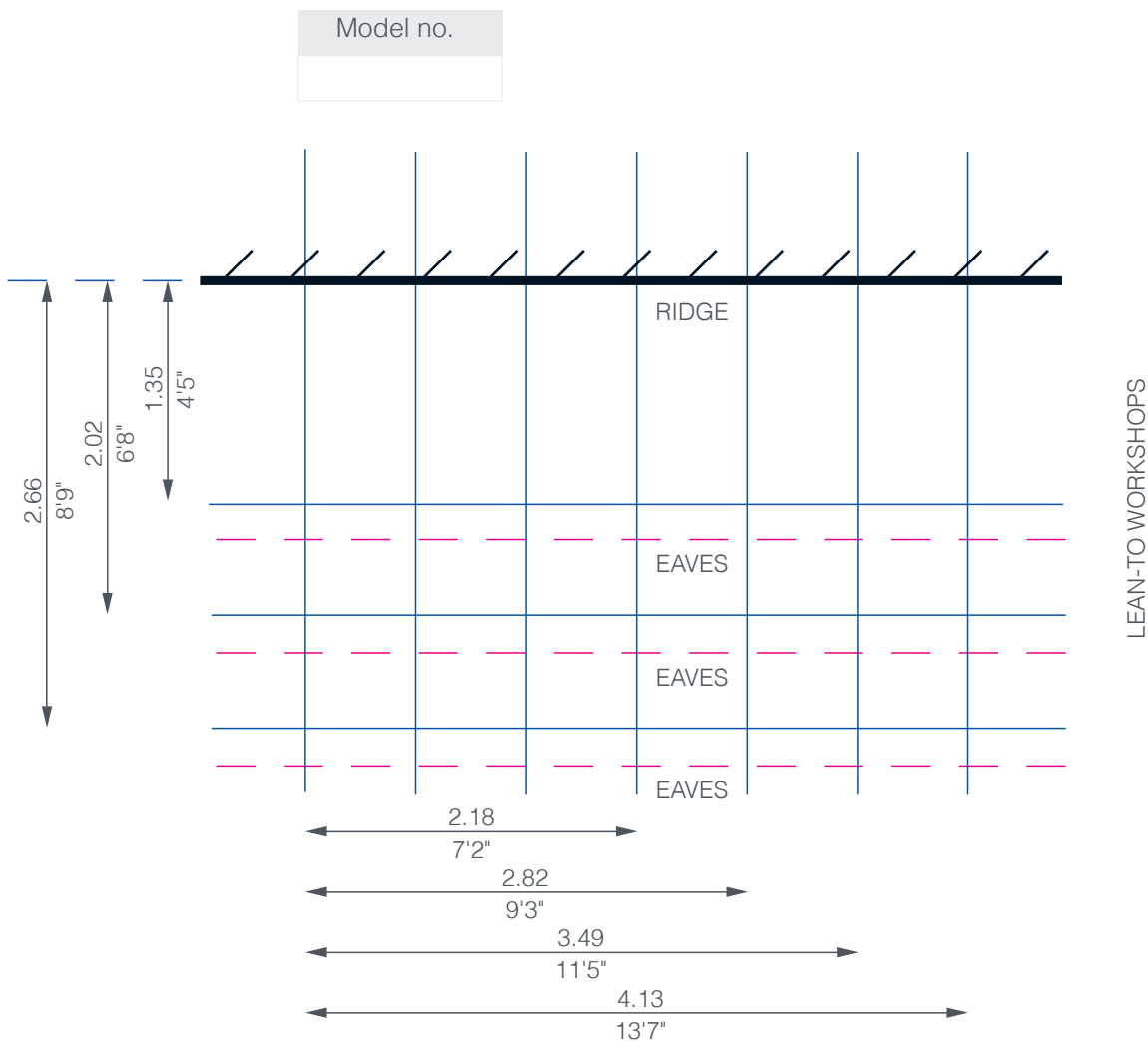

Use this form to plan your bespoke workshop. Wall panels come in 2 sizes, a single and a double. Use the blue grid to mark out the footprint of the size of workshop you want using a combination of these panels. Windows are in the double panels and mark these with a W. Standard doors come in double panels so mark these with D1, wide doors come in a double panel and single combined panel and are marked D2, and double doors come in a combined double panel marked D3. The purple lines show the roof overhang, which can be used to provide an external covered space should you wish. Use model(s) from the standard range to base your plan on. The width is limited to the sizes shown but the length can be as long as you want in multiples of the dimensions shown.

See the attached worked examples.

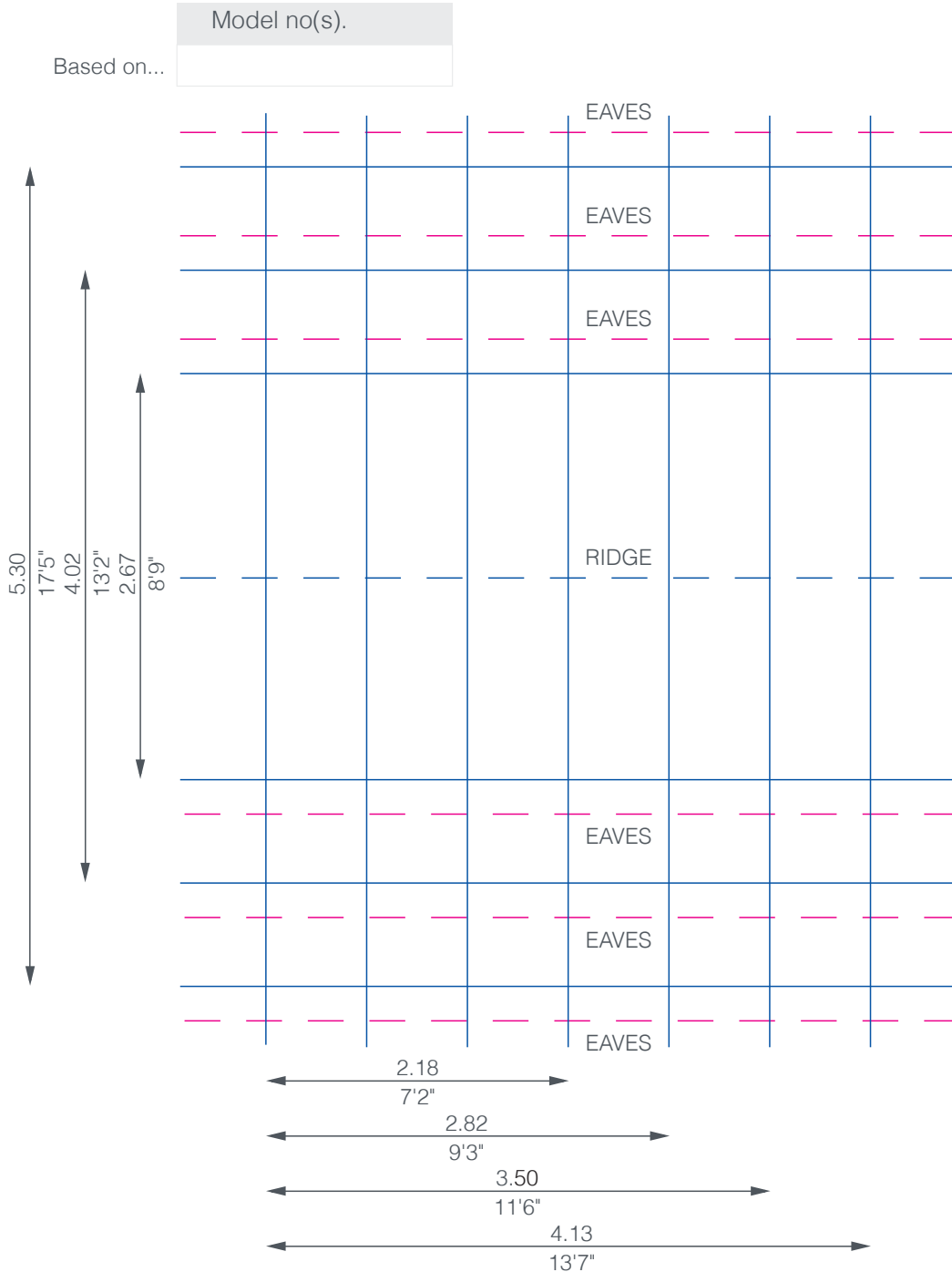

Notes